



# Installation Manual

## Integrated Day-Night™ Dome Camera

### WZ45N Series

#### About this manual

Before installing and using the camera, please read this manual carefully. Be sure to keep it handy for later reference.

#### Dimensions : mm

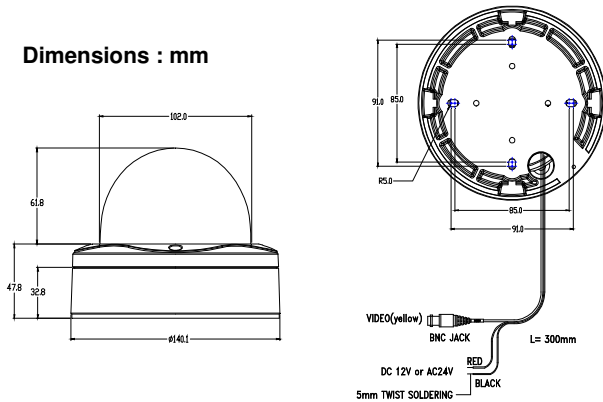

## TROUBLESHOOTING

Before sending the camera out for repair, check the items below. If the problem persists after checking these items, contact your service center.

#### ■ If no image appears

- Is the coaxial cable attached securely?
- Are the power and voltage normal?
- Has the iris of the lens inside the camera been adjusted correctly (with the level volume) ?
- Is there adequate illumination?

#### ■ If the image is unclear

- Is the lens in focus?
- Is the lens dirty?
- Dirt of fingerprints on the lens can adversely affect the images. Gently wipe any dirt or fingerprints off the lens with a soft cloth or lens cleaning paper and cleaning fluid (commercially available).
- Is the monitor adjusted correctly?

#### WARNING:

**TO PREVENT THE RISK OF FIRE OR ELECTRIC SHOCK, DO NOT EXPOSE THIS APPLIANCE TO RAIN OR MOISTURE.**

## PRECAUTIONS

- Do not put objects inside the unit  
Make sure that no metal objects or flammable substances get inside the camera. It could cause fire, short-circuits or damages.
- Be careful when handling the unit  
To prevent damage, do not drop the camera or subject it to strong shock or vibration.
- Install away from electric or magnetic fields
- Protect from humidity and dust
- Protect from high temperature  
Be careful when installing close to the ceiling, in a kitchen or boiler room, as the temperature may raise to high levels.
- Cleaning  
Dirt can be removed from the dome only by wiping it with a soft cloth moistened with a soft detergent solution.
- Mounting Surface  
The mounting surface material must be strong enough to secure the camera.

## CONNECTOR AND CAMERA SETTING

#### ■ CONNECTIONS

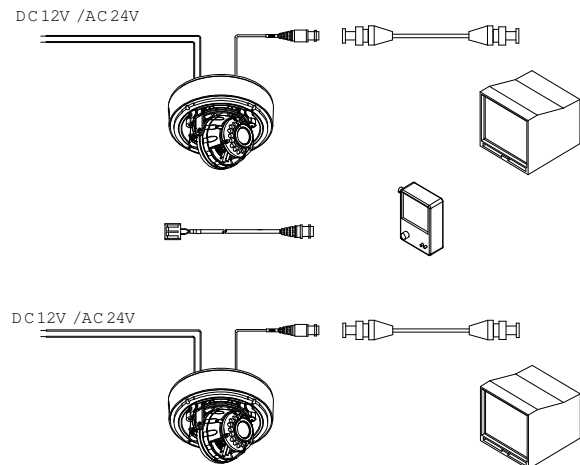

#### CAUTION :

Check for polarity when using a DC 12V or AC 24V power supply.

# CONNECTIONS AND CAMERA SETTINGS

## ■ LENS ADJUSTMENTS

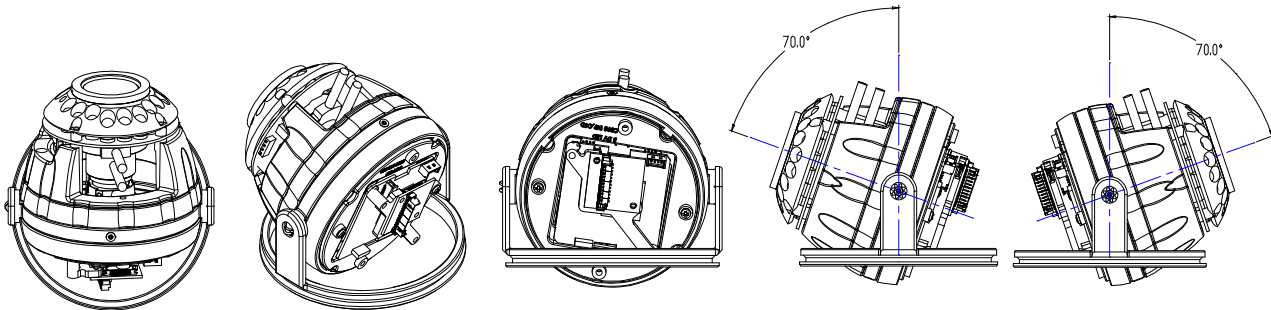

1. Adjust the panning(360°) and tilt(70°) position.
2. Setting the zoom position by using Zoom Lever Screw.
3. Setting the focus by using Focus Lever Screw.

## ■ CAMERA SETTINGS

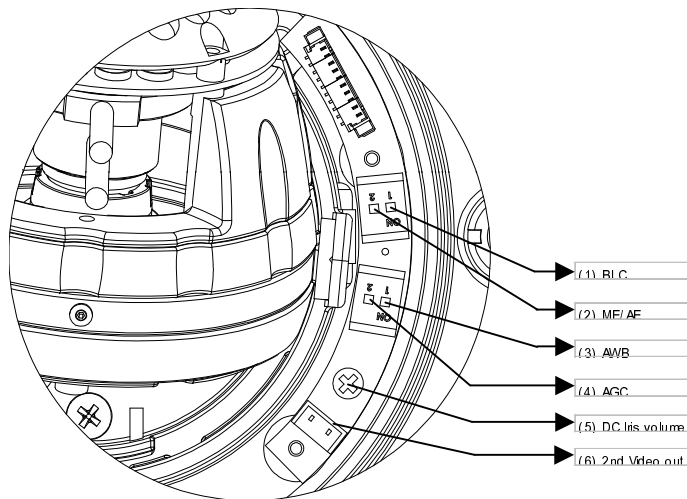

### ● DIP SWITCH FUNCTION

#### (1) Compensating for backlight

ON	When back light is so bright
OFF	Normal setting

**CAUTION** : It will be correctly set by adjusting DC Lens control.

#### (3) Confirming the White Balance

AWC	Use this under light source below 2500K and over 9500K of natrium.
ATW	Use this under lightsource between 2500K and 9500K of flourescent lamp ,incandescent light

#### (2) Confirming the iris setting

ME	The default setting when DC auto-iris lens is installed
AE	The default setting when fixed iris lens is installed

**CAUTION** : The iris setting is preadjusted as the best condition for use at time of factory shipment, so it isn't necessary to change settings

#### (4)Setting gain control (AGC)

For adjusting the sensitivity of the camera. Use this setting for shooting in dark environments.

ON	Normal setting
OFF	Set this when there is excessive noise

# SPECIFICATION

## Physical

Housing	Surface mount dome, vandal resistant
Gimbals	3D gimbal for easy installation
Voltage	12V to 24V AC/DC
Power Consumption	4.75W (Max)
Construction	Robust aluminum
Finish	Powder coat silver
Power Supply	Not included
Auxiliary Output	Local video out for easy video verification
Conduit Compatible	Yes
Operational Temperature	-30°C to +55°C   -22°F to 131°F
Storage Temperature	-50°C to +60°C   -58°F to 140°F
Environmental	IP66 certified

# INSTALLATION

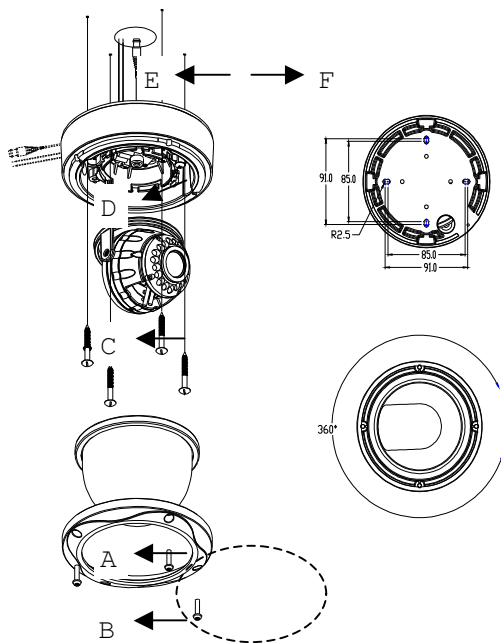

- 1 Use the supplied L-wrench to remove the four fixing screws (B) of dome cover (A).
- 2 Align the camera unit with the surface of the ceiling, make marks on the ceiling in the places where the screw holes are to be drilled, and then drill the four holes.
- 3 Cut a hole, 2.9in (73mm) in diameter, in the ceiling for routing the cables.
- 4 Pass the power cable (E) and video cable (F) from the camera unit through the cable hole in the ceiling.
- 5 Align the four screw holes in the camera unit (D) with the screw holes in the ceiling, and then secure the camera in place by tightening the four or more screws (C) through the washers.
- 6 Carry out the settings and adjustments for the camera.
- 7 Secure the dome cover (A) by tightening the screws (B).

**(5) Adjusting level volume**

If the entire image is too dark or bright, or the backlight compensation is not correct even after (1) is set to "ON", you need to adjust the level volume.

CCW (Low)	Closes the lens iris, making the entire image darker
CW(High)	Opens the lens iris, making the entire image brighter

**(6) SECOND VIDEO OUT CONNECTOR**

If installing with a portable monitor, this connector should be connected.

**Contact Information**

**Extreme CCTV Inc.**

**CANADA**

3021 Underhill Ave.  
Burnaby, BC  
V5A 3C2

**USA**

3888 Sound Way  
PO Box 9754  
Bellingham, WA 98226

N.A.: 1-888-409-2288 (N.A. toll free)  
Tel: +1-604-420-7711  
Fax: +1-604-420-3300  
E-mail: Sales@ExtremeCCTV.com  
Web: www.ExtremeCCTV.com

**Extreme CCTV UK Ltd.**

**EUROPE**

Derwent House  
Colbourne Crescent  
Cramlington, Northumberland  
England, NE23 1WB

Tel: +44 (0) 1670-730-187  
Fax: +44 (0) 1670-730-188  
E-mail: Sales@DerwentCCTV.com  
Web: www.DerwentCCTV.com